

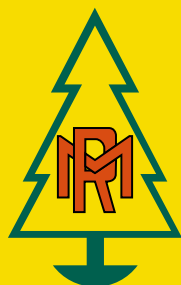

MONRA 600PS

FORESTRY HARVESTER



MONRA 600PS is a high capacity and high performance rotary header specifically designed to obtain reliability, quality, precision and versatility.

It is perfect for processing different types of trees, such as eucalyptus, pine, acacia, etc.

It works with most of the base machines on the market.

FELLING AND LOGGING

Cross-section cut chainsaw.
Output power: 40 Kw.
Type of chain: 404.
Length of blade: 670 mm.
Maximum cutting diameter: 600 mm.
Chain speed: 43 m/s.
Chain lubrication tank capacity: 8 l.
Automatic hydraulic tensioner.

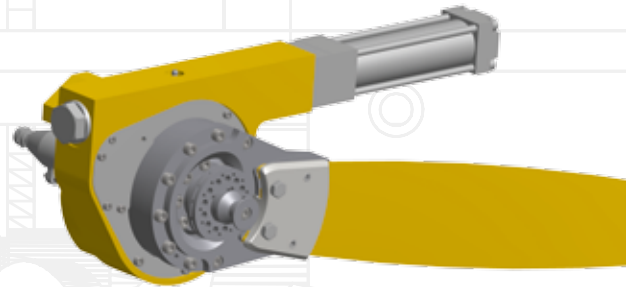

FEEDING MECHANISM

3 feeding rollers.
Two (2) 500 cc. high pressure hydraulic engines.
Two (2) 315 cc. high pressure hydraulic engines.
Feeding power: 28 KN.
Feeding speed: 6 m/s
(depending on the flow rate of the base machine).
Maximum opening of rollers: 600 mm.
Minimum opening of rollers: 50 mm.

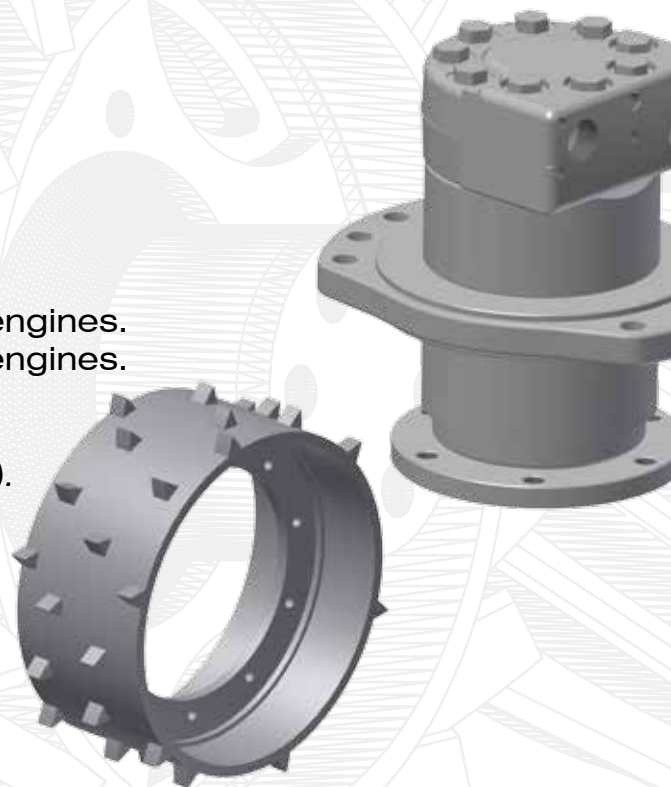

MEASUREMENT SYSTEM

Diameter: Located on the roller arms.
Length: Located between the saw and upper roller.

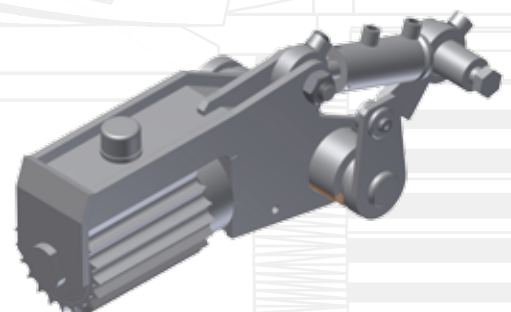

1

2

3

ROTATOR

Rotator indexer with maximum axial load of 16,000 Kg.
Unlimited rotation.
Controlled from header itself.



4

ELECTRONICS

NNmon600 is specifically designed for this header. It is a fast, simple, reliable and user-friendly control.



5

SIZE

Weight with rotator: 1350 kg.
Height with rotator: 1830 mm.
Length: 1470 mm.
Maximum width with closed rollers: 1340 mm.
Maximum width with open rollers: 1500 mm.

6

REQUIREMENTS OF BASE MACHINE

Minimum oil flow rate: 350 l/min.
Maximum pressure: 320 bar.

7



Our company holds and abides by the ISO 9001 quality control standard, which forces us to follow very strict standards of quality control during the whole manufacturing process.



ISO 9001

LL-C (Certification)

For each forestry harvester:

- Our technical department designs and calculates all components.
- Welding is done by highly trained and qualified personnel.
- Work is performed using highly accurate CNC machinery.
- Once finished, the entire work is tested and approved.



**TALLERES
RAMÓN CASTRO S. L.**

33794 Barres (Castropol)

ASTURIAS (España)

Tlfn: +34 985 62 40 30

e-mail: info@monraforestal.com

web: www.monraforestal.com